

Welcome to the Deutsches Museum
In 50 exhibit sections spread over 47,000 sqm, you can experience the development of science and technology from early origins through to the present day. The exhibition guide helps you make the most of your visit (available in the Museum and in the Museum Shop).

Open daily from 9.00 to 17.00; Kinderreich from 9.00 to 16.30; till 16.00
Closed on 1 January, Shrove Tuesday, Good Friday, 1 May, 1 November, 24, 25 and 31 December; on the 2nd Wednesday in December from 13.30.
Admission Adults€ 8.50 Concessions€ 7
School children & Students€ 3 Family ticket€ 17
Evening lectures€ 3
Combined ticket Deutsches Museum + Deutsches Museum Verkehrszentrum + Flugwerft Schleissheim€ 15
Members and children under 6 free.
Ten-visit-ticket including Hellabrunn Zoo ...€ 60

Public transport: All S-Bahn trains (to Isartor), U-Bahn routes 1 and 2 (to Fraunhoferstrasse), tram 18 (to Deutsches Museum) tram 17 (to Isartor), Bus 131 (to Boschbrücke).

Parking spaces are not available.

Become a member
Your annual fee of € 52 or € 25.50 for school children/students supports the Deutsches Museum and entitles you to visit the main museum and its branches at any time free of charge accompanied by one adult and 2 children (or all your own children up to the age of 16). Phone: 089/21 79-310.

Guided tours
Phone: 089/21 79-252. e-mail: fuehrungen@deutsches-museum.de
Tours for schools, general tours, specialist tours in German and other languages. Please book in writing 6 weeks in advance.

Taking photographs (using flash and video cameras) is permitted for private use; for commercial purposes, please phone: 089/21 79-475.

Wheelchair users have access to almost all exhibitions via ramps and lifts; the restaurant can be reached via lifts from the snack-bar. Our staff are happy to help. Toilets are on the ground floor and 1st floor.

Deutsches Museum,
Museumsinsel 1, 80538 München,
Phone: 089/21 79-1 · Fax 089/21 79-324
www.deutsches-museum.de

Self-service-Restaurant For reservations, call 089/21 01 94 78.
Snack-bar on the ground floor: self-service. Visitors may eat their own food here.
Internet Café on the 3rd floor (open till 16.00)
“Zwischenlandung”-Coffee Bar on the 2nd gallery level in Aeronautics

Deutsches Museum Shop: guides, catalogues and other Museum publications; wide selection of literature on the history of science and technology; model and experiment kits, technical toys.
Phone: 089/21 38-38 92; e-mail: info@deutsches-museum-shop.com
The **list of available publications** can be obtained in the Museum Shop.
The **library** is a reference library specialising in the history of science and technology. Phone: 089/21 79-224.

The **archives, special collections, documents library**, phone: 089/21 79-220, and picture service, phone: 089/21 79-231, are available for visitors’ use.
Kerschensteiner College offers courses for instructors, teachers and students. Phone: 089/21 79-243.

The **Research Institute for the History of Science and Technology** operates from the “Munich Centre for the History of Science and Technology”, collaborating with Munich’s Ludwig Maximilian University, the Technical University and the Armed Forces University, Munich. Phone: 089/21 79-280.

Visit the Deutsches Museum’s other branches

Deutsches Museum Verkehrszentrum
Theresienhöhe 14 a, 80339 Munich. Phone: 089/500 80 61 40 or 21 79-529
U-Bahn U4, U5 to Schwanthalerhöhe, Bus 131 (Mon.–Sa. Hans-Fischer-Str., Sun./holiday, Theresienhöhe).
Admission: day-ticket € 5, concessions € 3, Family ticket € 10
With the halls “Urban Transport”, “Travel”, “Mobility and Technology”, the Deutsches Museum presents its unique collection in the context of a new and unusual concept: transport as interaction between means of transport, infrastructure, planners and users.

Flugwerft Schleissheim
Effnerstr. 18, 85764 Oberschleissheim,
Phone: 089/31 57 14-0, fax: 089/31 57 14 50.
S-Bahn S1 to Oberschleissheim; by car via autobahn A99, exit Neuherberg.
Admission: day-ticket € 5, concessions € 3, Family ticket € 10

The Flugwerft Schleissheim displays aircraft, helicopters, engines, simulators and exhibitions on selected aspects of the history of aviation and space travel. This branch museum is about 13 km from Munich near the Schleissheim palaces.

Deutsches Museum Bonn
Ahrstr. 45, 53175 Bonn
Phone: 02 28 / 30 22 55, fax 02 28 / 30 22 54.
Admission: day-ticket € 4, concessions € 2.50.

The Deutsches Museum in Bonn’s Science Centre presents 100 highlights from research and development in Germany since 1945.

Tours and demonstrations for individuals and families (in German only)
Free of charge, except the Planetarium, and General tour; group tours, see “Guided tours”.
Meeting point: “Red Dot” near the entrance of the respective department. Please check first in the entrance hall whether “your” tour is still on.

Subject	Floor	Time			
General tour (2 1/2 hrs)	Entrance Hall	13.15	(€ 3 at the information desk)		
Aeronautics	G	10.30	14.30		
Aeronautics (historic)	1	10.00	14.00		
Agriculture/Food technology	3	11.30	14.00		
Altamira Cave	2	15.30	(Fridays only)		
Amateur radio (60 mins)	4	11.00			
Astronautics	2	11.00	15.00		
Ceramics/Pottery (mini-brickmaking machine)	2	10.00	14.00 (except Mon.)		
Chemistry (experiments) (very loud!)	1	11.00	13.00	15.00	(Tues.–Fri.) 13.00 15.00 (Sa.+ Sun.)
Computers/Mikroelectronics	3	15.00			
Electron microscope	1	14.30			
Energy technologies	1	14.00			
Geodesy	3	13.30	(Wed. – Fri.)		
Glass	2	11.00			
Glassblowing	2	11.30	14.00		
High-voltage unit (very loud!)	G	11.00	14.00	16.00	
Machine tools	G	10.00	15.00		
Marine navigation	G	10.30	14.30		
Metals: moulding and casting	G	10.30	14.30		
Metals: from ore to metal	G	11.00			
Mining (60 mins)	G	9.45	13.45		
Mining film (film forum)	B	10.45	14.45		
Modelrailway	G	11.00	14.00	16.00	
Musical instruments	1	10.30	14.00		
Observatory – West Dome	3	10.30			
Optics	1	13.00			
Paper (handmade)	2	10.30			
Pharmacology	1	11.30	14.00		
Planetarium	6	10.00	12.00	14.00	16.00
(€ 2, tickets at the information desk – children must be aged 6 or over)					
Power machinery	G	11.30	14.30		
Printing	2	13.30			
Telecommunications	3	13.00			
Observatory – East Dome (Entrance Museum courtyard, weather permitting)	3	21.00	(Tues. and Fri.)		

Ground floor

- | | |
|--|--------------------------------------|
| 1 Cloakroom | 15 a TUMlab |
| 2 Petroleum and natural gas | 16 Tunnel construction |
| 3 Metals | 17 Aeronautics |
| 4 Welding and soldering | (also 1 st floor, No. 26) |
| 5 Materials testing | 18 Bridge-building |
| 6 Machine tools | 19 Hydraulic engineering |
| 7 Power Machinery | 20 Outdoor exhibition area |
| 8 Machine components | 25 d Foucault pendulum |
| 9 Electrical power | |
| 10 Marine navigation | |
| 11 Federal President's Award for Technology and Innovation | Basement |
| 12 Closed during alterations | 21 Mining, dressing techniques |
| 13 Closed during alterations | 22 Kids' Kingdom |
| 14 Closed during alterations | |
| 15 Modelrailway | |

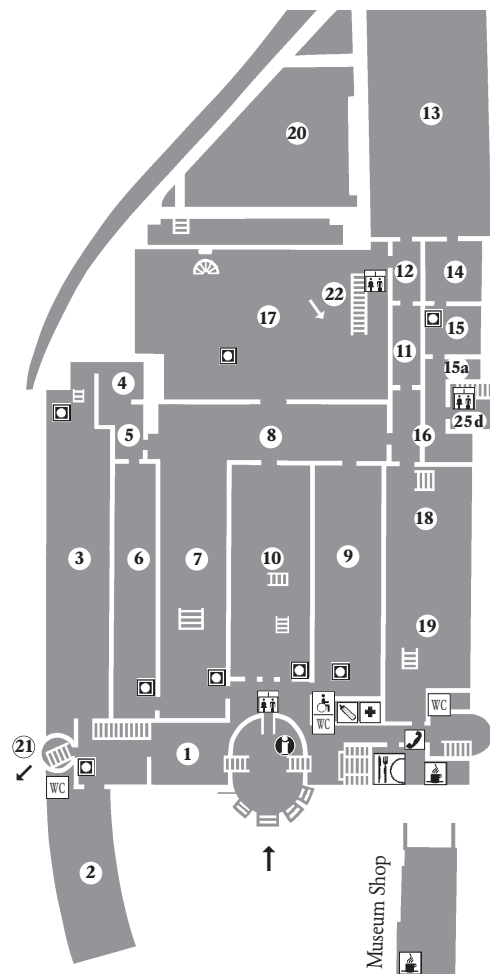







First floor

- | |
|-----------------------------|
| 23 Museum's history |
| 23a Academy collection |
| 24 Energy technologies |
| 25 Physics |
| 25a Optics |
| 25b Electron microscopes |
| 25c Nuclear Physics |
| 26 Aeronautics |
| (also ground floor, No. 17) |
| 27 Musical instruments |
| 28 Scientific chemistry |
| 29 Pharmacology |
| 30 Special exhibitions |



Key

-  WC for the disabled
-  Lift
-  Snack-bar, café
-  Restaurant
-  First aid
-  Telephone
-  Baby changing facilities
-  Meeting point for tours

Second floor

- | |
|-------------------|
| 31 Altamira Cave |
| 32 Ceramics |
| 32a Glassblowing |
| 33 Glass |
| 34 Technical toys |
| 35 Paper |
| 36 Printing |
| 37 Astronautics |
| 38 Foto + Film |
| 39 Textiles |
| 40 Environment |

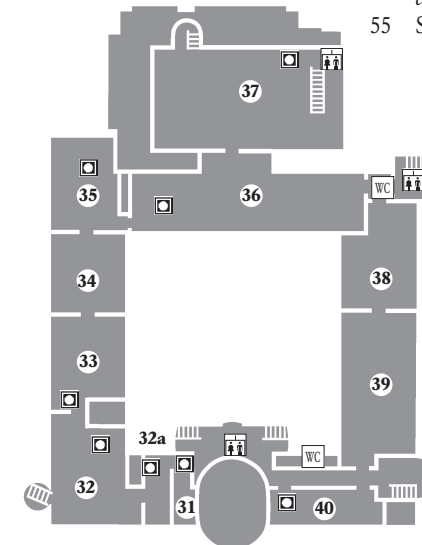

2nd floor

Third floor

- | |
|-------------------------|
| 41 Astronomy I |
| 42 Geodesy |
| 43 Computers |
| 44 Microelectronics |
| 45 Mathematical Cabinet |
| 46 Telecommunications |
| 47 Agriculture |
| 48 Food Technology |
| 49 Chronometry |
| 50 Weights and measures |

Fourth to sixth floors

- | |
|---|
| 51 Amateur astronomy |
| 52 Amateur radio |
| 53 Astronomy II |
| 54 Zeiss Planetarium |
| (€ 2, tickets at Information desk, children must be aged 6 or over) |
| 55 Sundial garden |

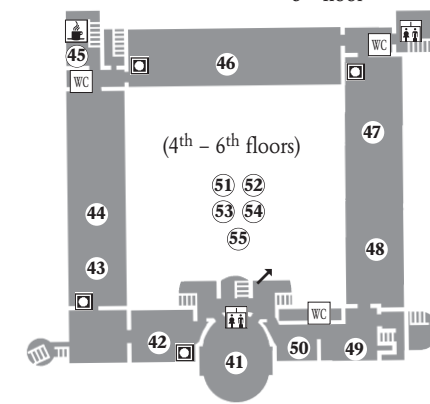

3rd floor